

The objective of the escape route signing system is to ensure that a sign or a series of signs is provided and placed so that a person is directed along the escape route from any space within a ship or a marine installation towards an assembly station or embarkation station. The signing system should be designed based on the means of escape plan, assembly station plan, and lifesaving plan. It should provide simple information that will make it easy to identify the means of escape provisions, allow people to escape with minimum assistance and avoid possible points of confusion.

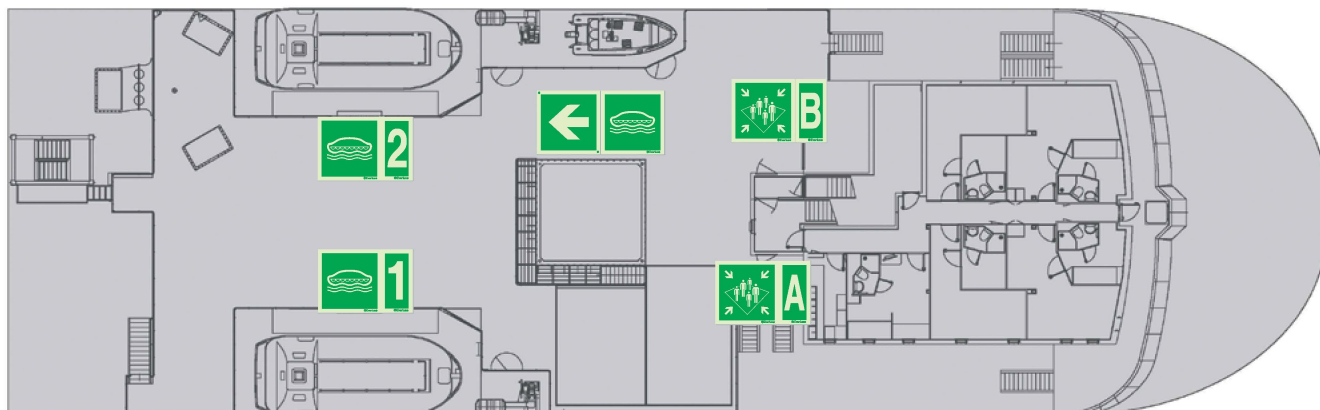

## ✈ MEANS OF ESCAPE SIGNS (MES)

### Direction to Helideck



(mm)  
150x150  
200x200  
300x300  
400x400



S 06 21

(mm)  
300x100  
400x120

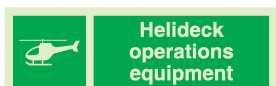

S 06 31



S 03 47



S 06 32



S 06 33



S 06 34



S 06 35



S 06 36



S 06 37



S 06 38



S 06 39

### Protection Shelter Signs

(mm)  
150x150  
200x200  
300x300  
400x400



S 06 01

(mm)  
300x100  
400x120



S 06 11



S 06 12



S 06 13



S 06 14



S 06 15



S 06 16



S 06 17



S 06 18

## Escape Route Signs in Compliance with IMO Resolution A.1116 (30), ISO 24409 and EN ISO 7010

Escape route signs take priority over any other signs. These should be installed at consistent intervals of up to 15m in order to make it easier for evacuees to predict the location of the next evacuation sign.

Escape route signs should be installed at the center line over the doors at a height between 2.0m and 2.5m from the deck to the base of the sign in order to assure visibility from any foot traffic area. The escape route signs that are to be installed on bulkheads should be installed between 1.5m and 2.0m. As far as it is possible, installation heights should be kept throughout the escape route.



## Escape Route Signs in Compliance with IMO Resolution A.1116 (30), ISO 24409 and EN ISO 7010





## ✚ MEANS OF ESCAPE SIGNS (MES)

### Escape Route Signs in Compliance with IMO Resolution A.1116 (30), ISO 24409 and EN ISO 7010

(mm)  
300x150



(mm)  
150x150(\*)  
200x200(\*)  
300x300  
400x400



(\*) Only available  
in this size

### Deck and Stair Identification Signs



(mm)  
300x100  
400x150  
600x200



### Number and Letter Supplementary Signs for Life-saving Equipment Marking and for other Identification Requirements

(mm)  
75x150  
100x200  
150x300  
200x400

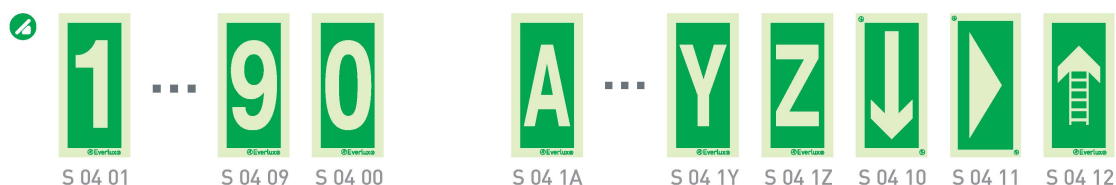

# Escape Route Signs for People with Reduced Mobility

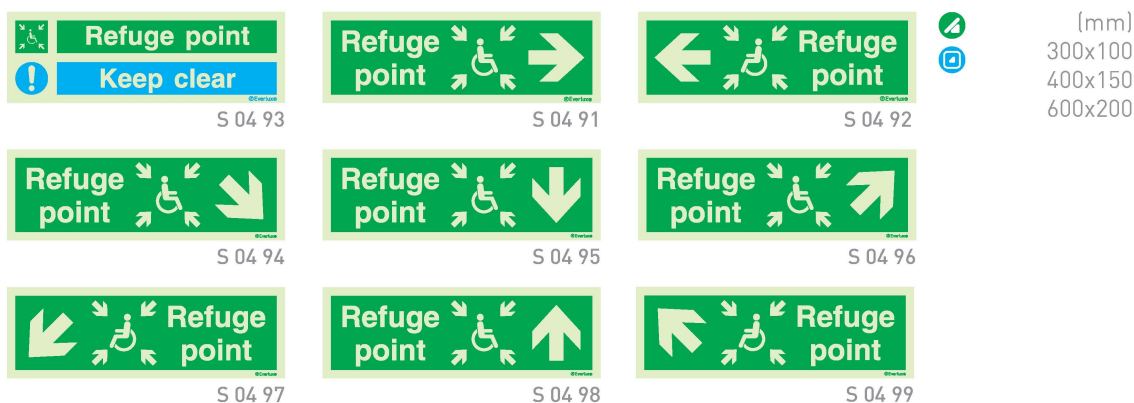
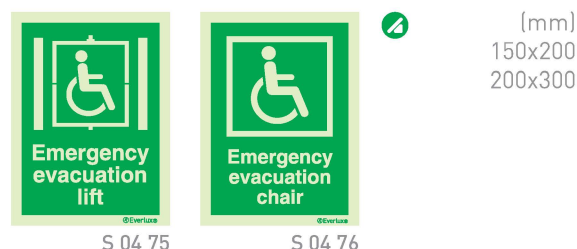

# Escape Door Opening Mechanism Signs

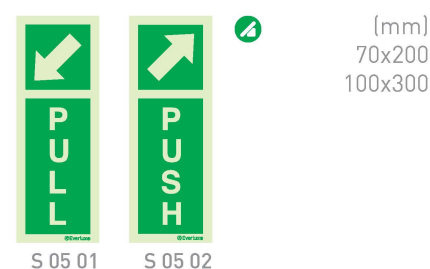

## MEANS OF ESCAPE SIGNS (MES)

### Escape Door Opening Mechanism Signs

(mm)  
75x150(\*)  
100x100(\*\*)  
100x240  
(\*) (\*\*) Only available in this size

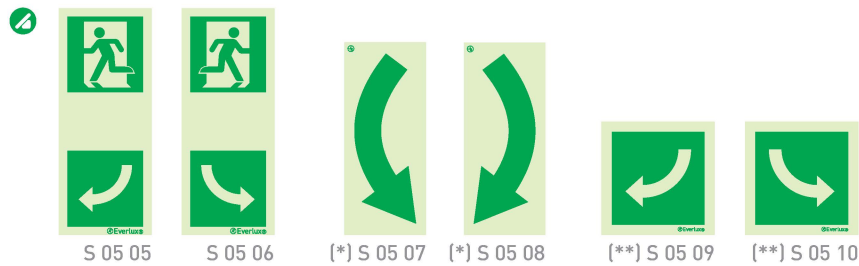

(mm)  
300x150  
400x200  
600x300

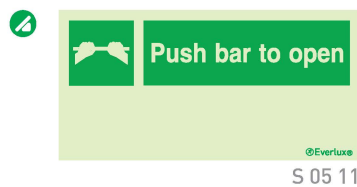

(mm)  
200x70(\*)  
300x100  
400x120  
600x200(\*\*)

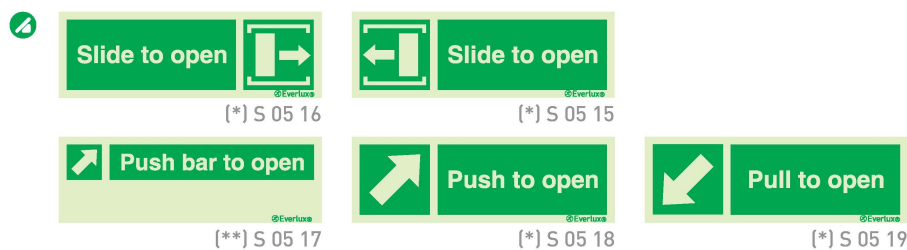

(mm)  
200x50  
300x70  
400x100



(mm)  
100x100(\*)  
150x150  
200x200  
300x300  
400x400(\*\*)



(mm)  
200x70  
300x100  
400x120



(mm)  
150x200  
200x300  
300x400

