



TCY-YKGL

2Way Pneumatic Cylinder Valve

The valve is emergency check/supply to flow of fluid in the system. Main valve is open/close as the air pressure supply/check at actuator. It's spring return type and it has various function with accessories.

• FEATURE

1. Simply construction and easy Installation.
2. No leakage and strongly.
3. Emergency operating is possible with emergency handle devices.
4. Valve has large capacity.

Specification

Model		TCY-YKGL	TCY-YKGL(PL)
Type		Cylinder	Cylinder(Pilot)
Applicable Fluids		Steam, Water, Oil	
Applicable Press. / Temp.		16 kgf/cm ² / 220°C	20 kgf/cm ² / 220°C
Air supply Pressure		5~7 kgf/cm ²	
Operation (Air fail)		Closed / Open	
Material	Body	Ductile Cast Iron, Bronze, Carbon Steel	
	Trim	Stainless Steel	
Size		65~300mm	
Accessories		Solenoid Valve / Limit Switch / Air Set	

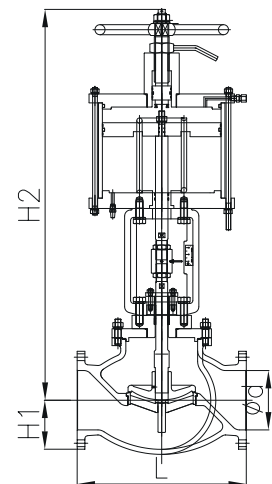

TCY-YKGL

Dimensions

Model	Size mm(inch)	d	L	H1	H2	H3	Weight Abt(Kg)
TCY-YKGL (PL)	65(2.1/2")	65	290	123	1090	920	47
	80(3")	80	310	141	1130	950	62
	100(4")	100	350	162	1170	980	70
	125(5")	125	390	176	1220	1030	86
	150(6")	150	451	213	1295	1095	115
	200(8")	200	552	253	1400	1182	145
	250(10")	250	688	270	1530	1290	180
	300(12")	300	889	280	1740	1460	230

- Notes : 1. Also available in JIS, DIN and ANSI. For all other standards please.
 2. Weights(Ductile Cast Iron) are approximate and applied JIS 10K.
 3. The Flanges shall conform by JIS B2220

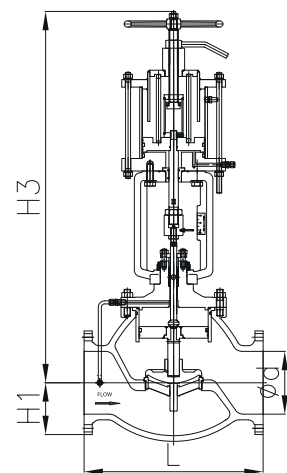

TCY-YKGL(PL)



TCY-YKAG(PL)

2Way Pneumatic Cylinder Valve

The valve is emergency check/supply to flow of fluid in the system. Main valve is open/close as the air pressure supply/check at actuator. It's spring return type and it has various function with accessories.

● FEATURE

1. Simply construction and easy Installation.
2. No leakage and strongly.
3. Emergency operating is possible with emergency handle devices.
4. Valve has large capacity.

Specification

Model		TCY-YKAG	TCY-YKAG(PL)
Type		Cylinder	Cylinder(Pilot)
Applicable Fluids		Steam, Water, Oil	
Applicable Press. / Temp.		16 kgf/cm ² / 220°C	20 kgf/cm ² / 220°C
Air supply Pressure		5~7 kgf/cm ²	
Operation (Air fail)		Closed / Open	
Material	Body	Ductile Cast Iron, Bronze, Carbon Steel	
	Trim	Stainless Steel	
Size		65~300mm	
Accessories		Solenoid Valve / Limit Switch / Air Set	

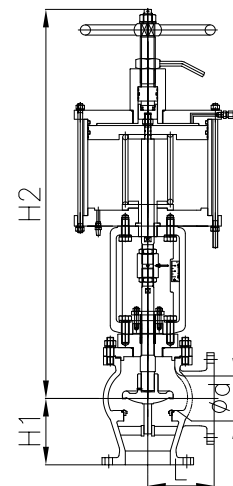

TCY-YKAG

Dimensions

Model	Size mm(inch)	d	L	H1	H2	H3	Weight Abt(Kg)
TCY-YKAG (PL)	65(2.1/2")	65	130	130	1030	850	33
	80(3")	80	150	150	1060	890	43.5
	100(4")	100	170	170	1140	945	49
	125(5")	125	200	200	1190	980	60
	150(6")	150	220	220	1297	1077	82
	200(8")	200	250	250	1330	1110	116
	250(10")	250	290	290	1380	1160	144
	300(12")	300	330	330	1410	1200	185

- Notes : 1. Also available in JIS, DIN and ANSI. For all other standards please.
 2. Weights(Ductile Cast Iron) are approximate and applied JIS 10K.
 3. The Flanges shall conform by JIS B2220

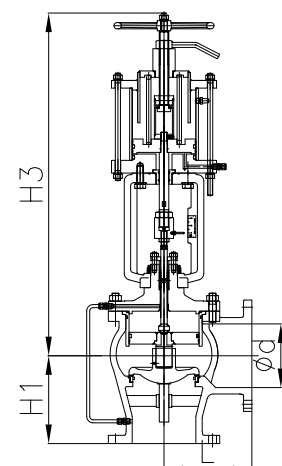

TCY-YKAG(PL)

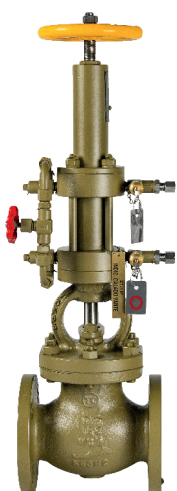

THA-GL



THA-AL

Hydraulic Linear Actuator

The valve is emergency check/supply to flow of fluid in the system. Main valve is open/close as the air pressure supply/check at actuator. It's spring return type and it has various function with accessories.

• FEATURE

1. Simply construction and easy Installation.
2. No leakage and strongly.
3. Emergency operating is possible with emergency handle devices.
4. Valve has large capacity.

Specification

Model	THA-GL	THA-AL
Type	Globe	Angle
Max. Operation Press.	120 Bar	
Viscosity of Hydraulic oil	Mineral oil, ISO VG 22~32	
Operating Pr. Open / Close	90 Bar / 80ar	
Ambit. Temp. Range	-20 to 80°C	
Accessories (Option)	Manual Handle / Indicator	

Dimensions

Model	Size mm(inch)	d	L	H1	H2	H3	A
THA-GS	50A	50	220	394	450	536	160
	65A	65	270	412	468	554	160
	80A	80	300	417	473	559	200
	100A	100	350	462	507	617	280
	125A	125	420	555	615	810	280
	150A	150	490	595	655	850	280
	200A	200	570	668	728	923	315
	250A	250	740	764	854	1134	355
THA-AL	300A	300	840	829	919	1199	450
	50A	50	120	364	420	506	160
	65A	65	130	372	428	514	160
	80A	80	140	372	428	514	200
	100A	100	160	407	452	526	280
	125A	125	180	490	550	745	280
	150A	150	205	525	585	780	280
	200A	200	230	583	463	838	315
	250A	250	290	655	745	1025	355
	300A	300	320	704	794	1074	450

* The Flange dimension is according to JIS 10K.

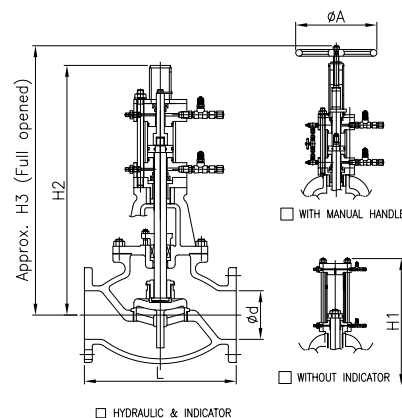

THA-GL

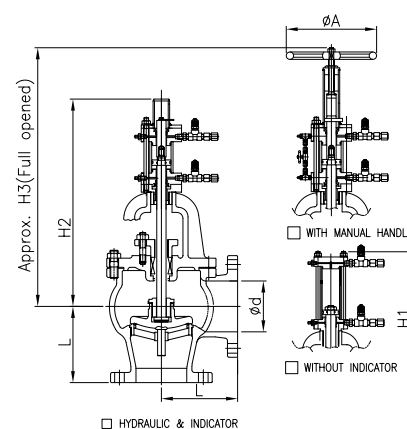

THA-AL

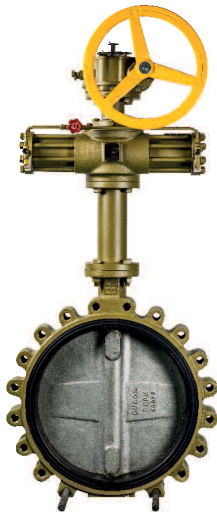

THRSY-00

Hydraulic Scotch Yoke Actuator

The Scotch yoke type is a method of connecting a yoke object with a valve. Is connected to the groove and moves along the piston moving in a linear motion, and the straight line is converted into a rotary motion and transmitted to the valve.

• FEATURE

1. It is simpler in structure than other actuator.
2. The operating speed is high.
3. It costs a lot while generating powerful power.

Specification

Model	THRSY-01	THRSY-02	THRSY-03	THRSY-04
Discharge (cc/rev.)	13	26	42	64
Max. Operation Press.	120 kgf/cm ²			
Open / Close Pressure	90 / 80 kgf/cm ²			
Applicable Temperature	-20 ~ 80°C			
Viscosity to Hydraulic Oil	Mineral Oil, ISO VG22~32			
Oil Full Capacity	1200	1250	1350	1400
Approx. Weight (without oil)	32	35	45	50
Accessories	Check & By pass Valve / Manual over ride / Limit switch			

Dimensions

Model	Size mm(inch)	H1	H2	H3	H4	H5	A	B
THR-DM	80A	180	90	100	60	160	300	350
	100A	180	90	100	60	160	300	350
	125A	180	90	100	60	160	300	350
	150A	180	90	100	60	160	300	350
	200A	240	125	140	85	180	440	500
	250A	240	125	140	85	185	440	500
	300A	260	150	160	85	185	510	575
	350A	260	150	160	85	185	510	575
	400A	260	150	160	85	185	510	575
	450A	260	150	160	85	185	510	575
	500A	330	206	166	154	185	640	705
	550A	330	206	166	154	185	640	705
	600A	330	206	166	154	185	640	705

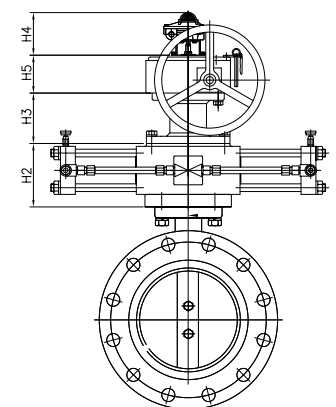
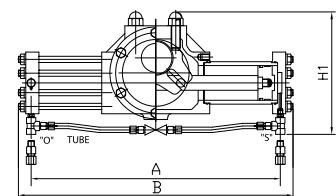

- Notes : 1. Also available in JIS, DIN and ANSI. For all other standards please.
 2. Weights(Ductile Cast Iron) are approximate and applied JIS 10K.
 3. The Flanges shall conform by JIS B2220

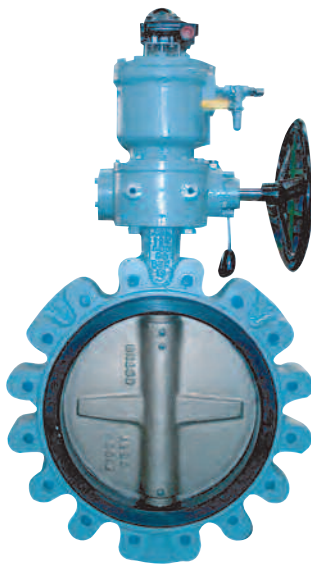

THARO-00

Hydraulic Rotary Actuator

This is occurrence to fan shape movement of piston by external pressure it back into rotation movement of a multitude gear to high torque. It can use on ball, butterfly, plug valve. The size of actuator is small and "DOUBLE ACTING TYPE".

• FEATURE

1. Compact and easy Installation.
2. It is no Damage of gear with internal balance type.
3. Having high torque.
4. Can be installed in both horizontal and vertical position.
5. Simply construction and strongly, it can keep sealing.
6. Emergency operating is possible with emergency handle devices.

Specification

Model		THARO-01	THARO-02	THARO-03	THARO-04	THARO-05	THARO-06
Max. torque at 210 Bar	N.m	547	1319	6517	13805	33600	51625
Torque at 120 Bar	N.m	313	754	3724	7889	19200	29500
Max. operation pressure	Bar	120					
Operating Pr. open/close	Bar	90 / 80					
Angle of rotation	°	90±5					
Ambient temperature range	°C	-20 to 80					
Viscosity of hydraulic oil	-	Mineral oil, ISO VG 22~32					
Accessories(Optional)	-	• Check & By-pass valve		• Manual Override		• Limit switch	

Dimensions

(mm)

Size mm(inch)	D	H1	H2	N	Torque at 120 Bar(N.m)	Weight Abt(Kg)
125A	105	260	95	125	313	8
150A	105	260	95	125	313	8
200A	140	300	95	125	754	10
250A	140	300	95	125	754	10
300A	187	330	110	155	3724	20
350A	187	330	110	155	3724	20
400A	187	330	110	155	3724	20
450A	187	330	110	155	3724	20
500A	187	330	140	200	3724	35
550A	187	330	140	200	3724	35
600A	280	442	162	250	7889	35
650A	280	442	180	250	7889	67
700A	280	442	180	250	7889	67
750A	280	442	180	250	7889	67

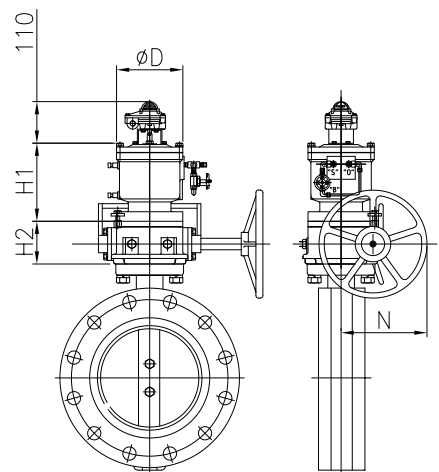

- Notes : 1. Also available in JIS, DIN and ANSI. For all other standards please.
 2. Weights(Ductile Cast Iron) are approximate and applied JIS 10K.
 3. The Flanges shall conform by JIS B2220



THT-1

Hydraulic Transmitter

The pump of transmitter internal is operated with press at specify and hydraulic force when handle right and lift operation. Tael valve is suitability at actuator operation and hydraulic transmitter remote control

● FEATURE

1. Installation simple and no auxiliary power is required
2. Handling is easy for occur of large capacity.
3. Suitability at difficult of access of people.
4. Leakage is no with check valve of high faculty.
5. This one has safety function by itself. So it can protect by itself.

Specification

Model	THT-1	THT-2	THT-3	THT-4
Discharge (cc/rev.)	13	26	42	64
Max. Operation pressure	120kgf/cm ²			
Open / Close pressure	90 / 80 kgf/cm ²			
Applicable Temperature	-20~80°C			
Viscosity to Hydraulic Oil	Mineral Oil, ISO VG22~ 32			
Oil Fill Capacity	1200	1250	1350	1400
Accessories	Self seal coupling / Lamp Box			

Dimensions

Model	D	H	H1	L	M	Weight Abt(Kg)
THT-T1	315	70	300	210	210	32
THT-T2	355	70	300	210	210	35
THT-T3	355	70	300	210	210	45
THT-T4	450	70	300	210	210	50

(mm)

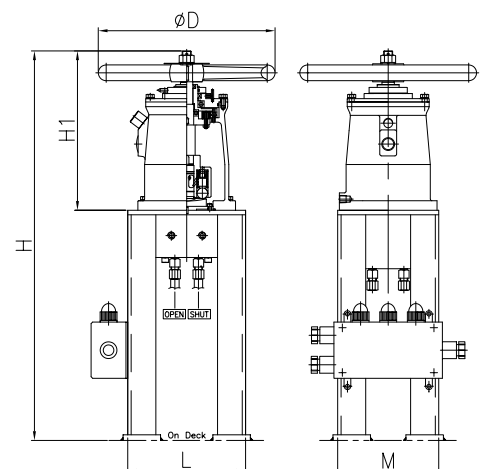



TAV-FL

Auto Air Vent

Ball float type for liquids automatically discharges the air accumulate in the pipes or pressure vessels to smooth the flow of liquid service.

• FEATURE

1. No chattering and water-hammer
2. No leakage and precise operation
3. Small size of course high capacity discharge.
4. Suitability at high temperature and pressure.
5. Stability performance for float type

Specification

Model		TAV-FL
Type		Ball Float
Applicable Fluids		Water, Oil
Applicable Press./Temp.		16 kgf/cm ² / 150°C
Material	Body	Ductile Cast Iron, Cast Steel
	Trim	Stainless Steel
Size		15~25 mm

Dimensions

Size mm(inch)	d	L	G	H	Weight Abt(Kg)
15(1/2")	15	128	130	110	13
20(3/4")	20	128	130	110	15
25(1")	25	128	132	110	18

(mm)

- Notes : 1. Also available in JIS, DIN and ANSI. For all other standards please.
 2. Weights(Ductile Cast Iron) are approximate and applied JIS 10K.
 3. The Flange shall conform by JIS B2220.

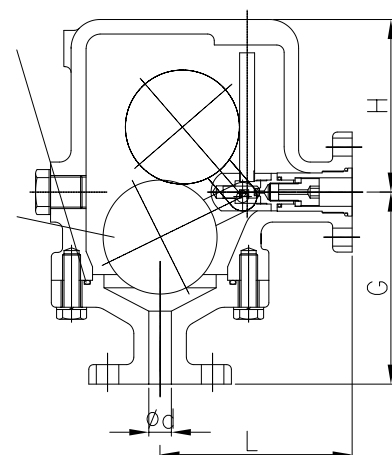



TAT-FL

Auto Air Trap

Ball float type for liquids automatically discharges the condensation water in the gas system.

• FEATURE

1. Stability performance for float type
2. No trim damage by pressure balance type
3. Suitability at high temperature and pressure. easy installed.

Specification

Model		TAT-FL
Type		Ball Float
Applicable Fluids		Compressed Air
Applicable Press./Temp.		Max. 30 kgf/cm ² / 150°C
Material	Body	Cast Steel
	Trim	Stainless Steel
Size		15~25 mm

Dimensions

Size mm(inch)	d	L	G	H	Weight Abt(Kg)
15(1/2")	15	226	153	110	13
20(3/4")	20	230	153	110	14
25(1")	25	230	153	110	15

(mm)

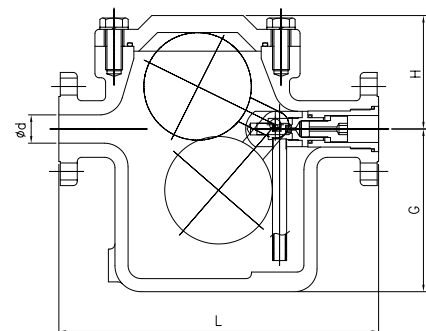

TAT-FL

Notes : 1. Also available in JIS, DIN and ANSI. For all other standards please.

2. Weights(Ductile Cast Iron) are approximate and applied JIS 10K.

3. The Flange shall conform by JIS B2220.

Steam Trap

Steam Trap is an automatic valve designed to automatically discharge steam condensate in the steam space and to prevent the leakage of steam. Efficiently removes condensate from piping and equipment to increase heat transfer efficiency, prevent piping corrosion, and provide smooth steam.

• FEATURE

1. Simple structure, small size, low failure and easy maintenance.
2. It can also be used for high pressure and superheated steam.
3. It is not affected by water hammer and vibration.

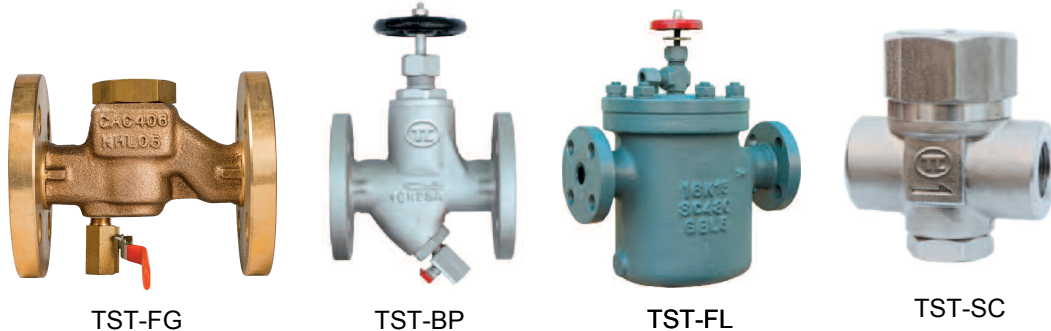

Specification

Model		TST-FG	TST-BP	TST-FL	TST-SC
Type		Disc	By-Pass	Ball Float	Disc
Applicable Fluids		Sat. Steam			
Applicable Press./Temp.		16 kgf/cm ² / 220°C			30 kgf/cm ² / 400°C
Material	Body	Ductile Cast iron, Bronze, Cast Steel			SUS410
	Trim	Stainless Steel			
Size		15~40 mm	15~25 mm	15~25 mm	8~10 mm

Dimensions

(mm)

Model	Size mm(inch)	Ød	L	G	H	PTA	Weight Abt(Kg)
TST-FG	15(1/2")	15	136	63	-	-	3
	20(3/4")	20	140	63	-	-	6
	25(1")	25	150	65	-	-	6
	32(1.1/4")	32	190	75	-	-	6
	40(1.1/2")	40	190	75	-	-	8
TST-BT	15(1/2")	15	136	130	150	-	4
	20(3/4")	20	140	130	150	-	6
	25(1")	25	150	130	150	-	8
TST-FL	15(1/2")	15	226	110	153	-	13
	20(3/4")	20	230	110	153	-	14
	25(1")	25	230	110	153	-	15
TST-SC	8(1/4")	-	50	24	40	PT 1/4"	0.5
	25(1")	-	50	24	40	PT 1/4"	0.5

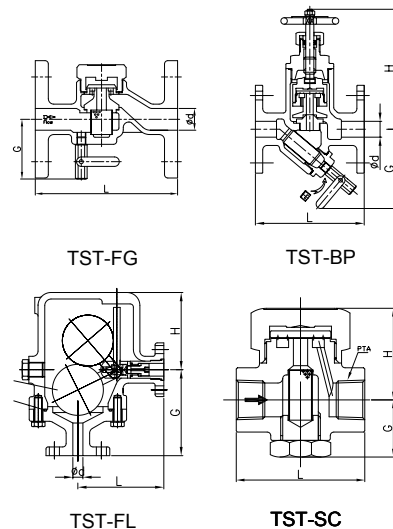

- Notes :
1. Also available in JIS, DIN and ANSI. For all other standards please.
 2. Weights(Ductile Cast Iron) are approximate and applied JIS 10K.
 3. The Flanges shall conform by JIS B2220



Steam Trap (High Pressure / Temperature)

This steam trap is suitable for high temperature and high pressure especially when it is used for power generation.

Thermodynamic Type Steam Trap, also called Disc Trap, operates by the speed difference between steam and condensate.

Simple structure, small size, low failure and easy maintenance.

It can also be used for high pressure and superheated steam, and is not affected by water hammer and vibration



TST-HPT

Specification

Model		TST-HPT
Type		Disc Type
Applicable Fluids		Sat. Steam
Applicable Press. / Temp.		Max. 250 kgf/cm ² / 425°C
Material	Body	Forged Steel
	Trim	Stainless Steel
Size		15~50mm
Connection		Socket Weld

Dimensions

(mm)						
Model	Size mm(inch)	d	L	H1	H2	Weight Abt(Kg)
TST-HPT	15(1/4")	21.7	65	25	143	5
	20(1/2")	27.2	65	25	143	8
	25(1")	34	80	37	160	8
	32(1.1/4")	42.7	80	37	160	10
	40(1.1/2")	48.6	95	45	185	11
	50(2")	61.2	107	60	232	15

Notes : 1. Also available in JIS, DIN and ANSI. For all other standards please.

2. Weights are approximate and applied 250K.

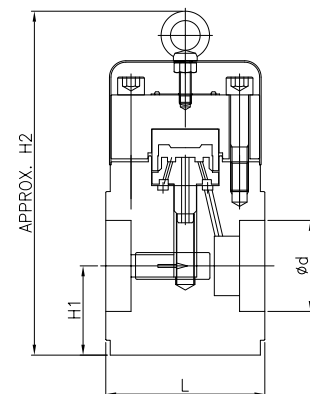

TST-HPT



Vacuum Breaker

Use on due to vacuum occur of gas, liquid in system for damage of instrument, malfunction prevention, smoothly drain etc.

TVB-FG : Easy to control the pressure of vacuum and used soft disc for leakage zero.

TVB-SC : It can stand under water hammer, high pressure/temp because of ball type disc.

Specification

Model		TVB-FG	TVB-SC
Type		Spring Loading	Ball
Applicable Fluids		Air, Sea Water, Oil	Air, Steam, Sea Water, Oil
Applicable Press./Temp.		10 kgf/cm ² / 150°C	20 kgf/cm ² / 220°C
Material	Body	Stainless Steel, Brass	
	Trim	Stainless Steel	
Size		15~25, 50, 100 mm	PT 1/2"

Dimensions

(mm)						
Model	Size mm(inch)	D	H	G	PT	Weight Abt(Kg)
TVB-FG	15(1/2")	15	184	-	-	3
	20(3/4")	20	184	-	-	3
	25(1")	25	184	-	-	4
	50(2")	50	195	-	-	8
	100(4")	100	225	-	-	13
TVB-SC	15(1/2")	-	50	24	1/2"	1

Notes : 1. Also available in JIS, DIN and ANSI. For all other standards please.
 2. Weights(Ductile Cast Iron) are approximate and applied JIS 10K.
 3. The Flanges shall conform by JIS B2220.

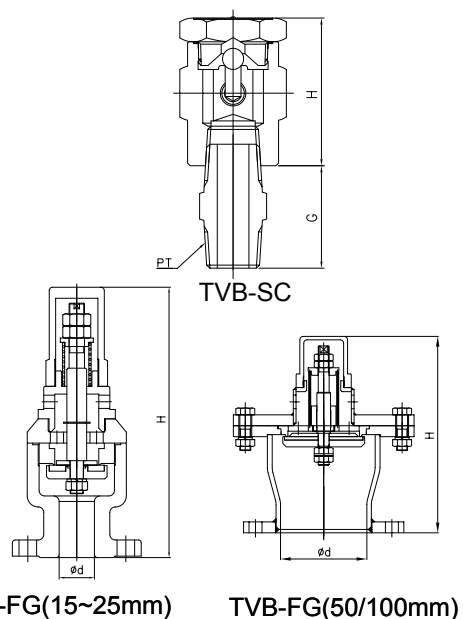



TYS-LP

Y-Strainer

It is prevent break down and a raise durability, cost reduction because it is filtering the foreign matter within screen inter valve. Generally used to high price valve, high price pump and important equipment.

• FEATURE

1. Pressure drop has little more than at fluid through area wild.
2. Suitability at high temperature and pressure.
3. Compact and easy installed.
4. Easy maintenance

Specification

Model		TYS-LP	TYS-HP
Type		"Y" Type	
Applicable Fluids		Air, Steam, Liquid	
Applicable Press./Temp.		20 kgf/cm ² / 220°C	40 kgf/cm ² / 220°C
Material	Body	Ductile Cast Iron, Bronze, Cast Steel	
	Trim	Stainless Steel	
Mesh(Screen)		20, 40, 60, 80, 100	
Size		15~300 mm	15~50 mm

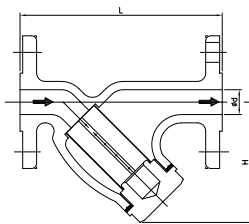
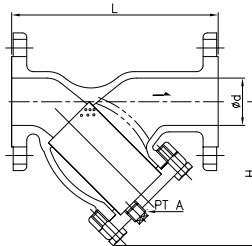
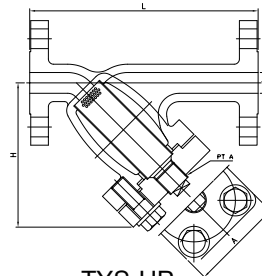
TYS-LP
(15~50)TYS-LP
(65~300)TYS-HP
(15~50)

Dimensions

(mm)

Model	Size mm(inch)	d	H	G	PTA	Weight Abt(Kg)
TYS-LP	15(1/2")	15	126	90	-	2
	20(3/4")	20	130	90	-	3
	25(1")	25	150	105	-	4
	32(1.1/4")	30	165	105	-	5
	40(1.1/2")	40	180	120	-	7
	50(2")	50	200	145	-	8
	65(2.1/2")	65	260	185	PT 3/8"	10
	80(3")	80	292	215	PT 3/8"	15
	100(4")	100	350	270	PT 1/2"	25
	125(5")	125	410	325	PT 1/2"	37
	150(6")	150	460	350	PT 1/2"	54
	200(8")	200	542	420	PT 3/4"	75
TYS-HP	250(10")	250	680	525	PT 3/4"	130
	300(12")	300	848	792	PT 3/4"	220
	15(1/2")	15	220	140	PT 3/8"	8
	20(3/4")	20	220	140	PT 3/8"	9
	25(1")	25	240	170	PT 3/8"	11
	32(1.1/4")	32	315	180	PT 3/8"	15
	40(1.1/2")	40	315	180	PT 3/8"	16
	50(2")	50	355	213	PT 3/8"	18

- Notes : 1. Also available in JIS, DIN and ANSI. For all other standards please
 2. Weight (Ductile Cast Iron) are approximate and applied JIS 10K.
 3. The Flange shall conform by JIS B2220
 4. TYS-HP : The Flange dimension is according to JIS 40K.



30K Globe / Angle Air Valve

JIS F 7475 – JIS 30K Cast Steel Globe Valve

JIS F 7340 – JIS 30K Cast Steel Angle Valve

Specification

Model		JIS F7340	JIS F7475
Type		Globe / Globe Check	Angle / Angle Check
Applicable Fluids		Air	
Applicable Press./Temp.		30 kgf/cm ² / 80°C	
Material	Body	Cast Steel	
	Trim	Stainless Steel	
Size		32~200 mm	

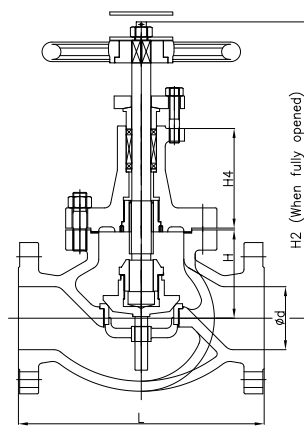

JIS F 7340

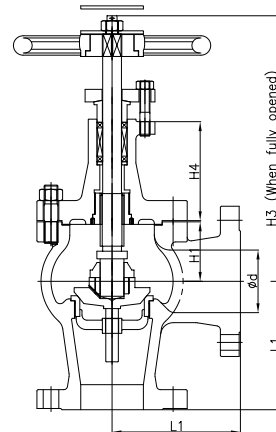

JIS F 7475

Dimensions

(mm)

Model	Size mm(inch)	L	L1	H	H1	H2	H3	H4
JIS F7340 JIS F7445	32(1.1/4")	220	114	85	60	270	245	86
	40(1.1/2")	240	121	85	60	280	255	90
	50(1")	260	146	105	75	350	310	112
	65(2.1/2")	310	165	120	80	390	340	127
	80(3")	340	178	125	85	430	380	141
	100(4")	390	25	140	95	480	435	162
	125(5")	470	230	170	110	570	510	189
	150(6")	540	250	200	130	655	585	220
	200(8")	680	300	240	160	720	685	255

Notes : 1. Also available in JIS, DIN and ANSI.

2. The Flange shall conform by JIS B2220

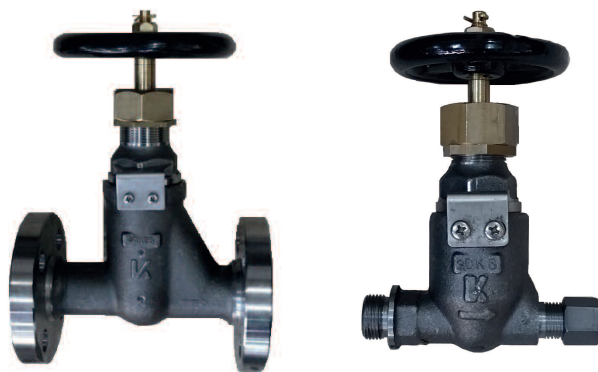

Globe Valve

Forged Globe Valve

JIS F7421 – JIS 20K Forged Steel Globe Valve

JIS F7336 – JIS 30K Forged Steel Globe Valve

JIS F7329 – JIS 40K Forged Steel Globe Valve

Specification

Model		JIS F7421	JIS F7336	JIS F7329
Type		“S”, “U”, “F” type		
Applicable Fluids		Air, Steam, Liquid		
Applicable Press.(kgf/cm ²)		20 kgf/cm ²	30 kgf/cm ²	40 kgf/cm ²
Applicable Temp.		MAX. 220°C		
Material	Body	Forged Steel		
	Trim	Carbon Steel		
Size		6mm, 10mm, 15~40mm		

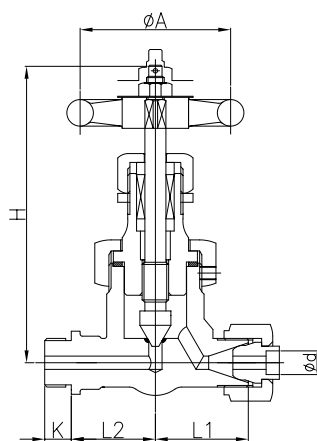

U TYPE

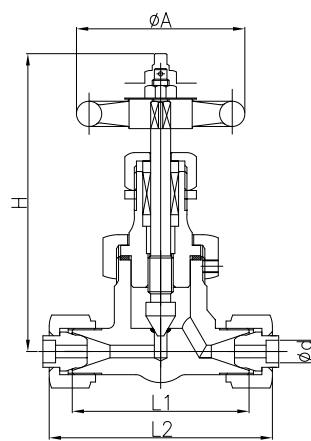

S TYPE

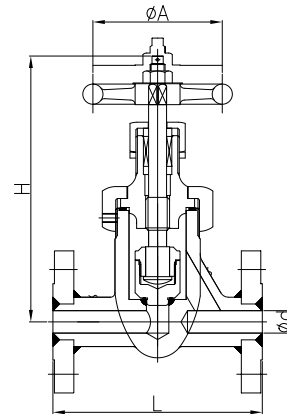

F TYPE

Dimensions

(mm)

Model	Size	d	L1	L2	K	H	øA	Weight Abt.(kg)
TGS-20 (U type)	6A	6	42	38	12	142	80	1.6
	10A	10	51	45	16	142	80	1.9
TGS-20 (S Type)	6A	6	84	102	-	142	80	1.5
	10A	10	102	126	-	142	100	1.8
TGS-20 (F Type)	15A	15	140	-	-	190	100	2.9
	20A	20	160	-	-	190	125	3.9
	25A	25	180	-	-	233	140	5.6
	32A	32	180	-	-	283	160	7.4
	40A	40	200	-	-	283	160	9.3

Notes : 1. Also available in JIS, DIN and ANSI. For all other standards please

2. Weight are approximate and applied JIS 20K.

3. The Flange shall conform by JIS B2220



Angle Valve

Forged Angle Valve

JIS F7422 – JIS 20K Forged Steel Angle Valve

JIS F7337 – JIS 30K Forged Steel Angle Valve

JIS F7330 – JIS 40K Forged Steel Angle Valve

Specification

Model		JIS F7422	JIS F7337	JIS F7330
Type		“S” , “U” , “F” type		
Applicable Fluids		Air, Steam, Liquid		
Applicable Press.(kgf/cm²)		20 kgf/cm²	30 kgf/cm²	40 kgf/cm²
Applicable Temp.		MAX. 220°C		
Material	Body	Forged Steel		
	Trim	Carbon Steel		
Size		6mm, 10mm, 15~40mm		

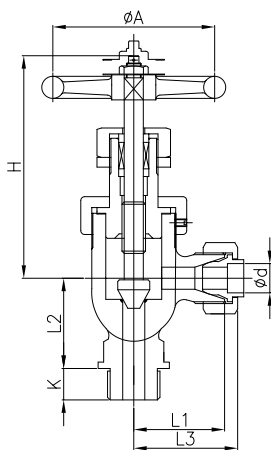

U TYPE

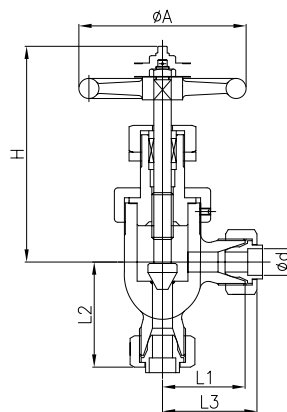

S TYPE

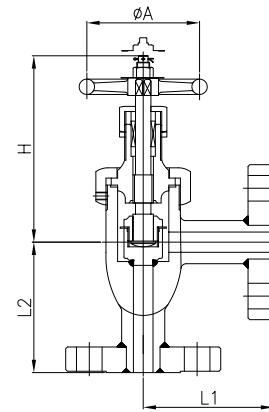

F TYPE

Dimensions

(mm)

Model	Size	d	L1	L2	L3	K	H	ØA	Weight Abt.(kg)
TAS-20 (U type)	6A	6	51	38	60	12	130	80	1.5
	10A	10	48	43.5	60	16	130	100	1.8
TAS-20 (S Type)	6A	6	51	50	60	-	130	80	1.2
	10A	10	48	61.5	60	-	130	100	1.8
TAS-20 (F Type)	15A	15	75	75	-	-	165	100	2.8
	20A	20	80	80	-	-	170	125	3.8
	25A	25	95	95	-	-	196	140	5.4
	32A	32	120	120	-	-	234	160	7.0
	40A	40	120	120	-	-	234	160	8.8

Notes : 1. Also available in JIS, DIN and ANSI. For all other standards please

2. Weight are approximate and applied JIS 20K.

3. The Flange shall conform by JIS B2220



TFR-PG

Manual Flow Regulating Valve

It is a valve that controls the flow rate by manually adjusting the opening degree of the valve, and the line port is built in so that the flow rate can be adjusted accurately.

Specification

Model		TFR-PG	TFR-CG
Type		Plug Type	Cage Type
Applicable Fluids		Air, Oil, Water	
Applicable Press./Temp.		20 kgf/cm ² / 220°C	
Material	Body	Ductile Cast Iron, Cast Steel, Bronze	
	Disc	Cast Bronze / Stainless Steel	
	Seat	Stainless Steel	
Size		15~25mm	32~300mm

Dimensions

(mm)					
Model	Size (mm)	L	H1	H2	Weight Abt.(kg)
TFR-PG	15	136	58	370	8
	20	140	58	370	8.5
	25	150	63	382	10
TFR-CG	32	190	79	390	15
	40	190	79	390	16
	50	222	106	502	20
	65	290	123	510	28
	80	313	141	538	40
	100	350	162	645	52
	125	390	176	653	68
	150	451	218	700	97
	200	559	253	800	127
	250	673	270	950	162
	300	741	280	960	202

- Notes : 1. Also available in JIS, DIN and ANSI. For all other standards please
 2. Weight (Ductile Cast Iron) are approximate and applied JIS 10K.
 3. The Flange shall conform by JIS B2220

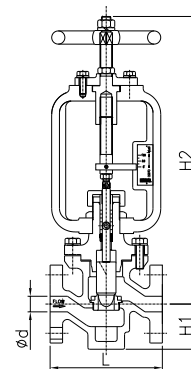

TFR-PG

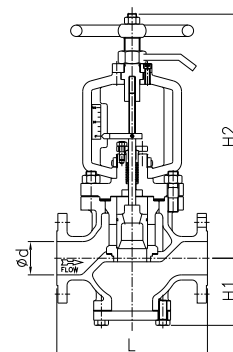

TFR-CG

Bellows Valve

Using a metal bellows, this valve achieves high airtightness. Because there is no possibility of leakage from the gland part, Suitable for applications requiring leak-proof performance

Specification

Model		TBV-GL	TBV-AL
Type		Globe	Angle
Applicable Fluids		Thermal Oil, Steam, Gas	
Applicable Pressure		16 kgf/cm ²	
Applicable Temperature		250°C	
Material	Body	Forged Steel / Carbon Steel	
	Trim	Stainless Steel	
Size		15~125mm	15~65mm

Dimensions

Model	Size (mm)	L	H1	H2	Weight Abt.(kg)
TBV-AG	15	75	238	313	5
	20	80	238	318	7
	25	95	255	350	12
	32	95	246	341	16
	40	100	250	350	20
	50	120	265	385	28
	65	130	300	430	45
TBV-GL	15	130	248	295	7
	20	150	248	298	9
	25	160	265	327	15
	32 / 40	190	300	380	22
	50	200	303	385	37
	65	230	364	456	48
	80	310	400	550	61
	100	350	490	655	86
	125	390	555	7.5	105

(mm)

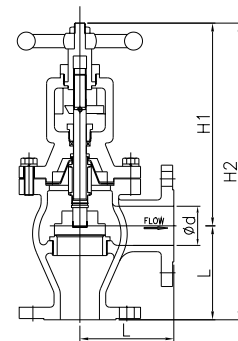

TBV-AG

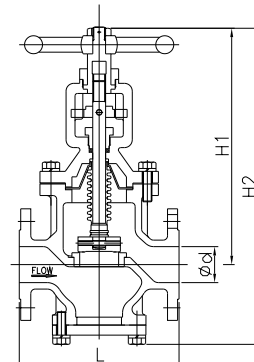

TBV-GL

- Notes : 1. Also available in JIS, DIN and ANSI. For all other standards please
 2. Weight (Ductile Cast Iron) are approximate and applied JIS 10K.
 3. The Flange shall conform by JIS B2220



E & P Controller (E&P-D1, 02)

E&P-02 Controller, digital type electro-pneumatic controller is designed to control Process variables such as pressure, temperature, liquid level and so on.

It provides All the latest digital electronic control functions with reliability & precision of a pneumatic Controller. Controller is composed of several major parts including Digital Signal Processor, flash ROM for program/data storage, analog-digital signal filter, WatchDog circuits, RS232/485 Communication interface & a pair of solenoid valves and etc..

The algorithm for PID control & auto-tuning was adopted as control software.

Electro-Pneumatic Controller operates that It accepts the signals standard 4~20mA and/or Pt100 from a sensor (transmitter), and CPU forward output signal,

To be calculated by PID. It'll provide Pneumatic output to operate diaphragm or piston actuated control valves.

Because this feature E&P-02 doesn't use I/P transducer and/or valve Positioner, it operates actuator directly thus reducing the costs

• FEATURE

- Micom controller that apply the newest technology.
- It is FND Display type which is easy to check and good for temperature character.
- P, PI, PID, Auto-Tuning faculty.
- Supply to insert direct current 24voltage for Transmitter.
- Display process Progress Value(PV), Setting Value(SV), Deviation Value(DEV), Min /Max, Unit etc.
- Built in remote monitoring faculty.
- Simple design and economic.
- Various input to RTC, Transmitter, Thermocouple.
- Quality guaranteed to achieved CE_EMC



Specification

Model	E&P-01	E&P-02
Supply Voltage	110/220VAC,50/60Hz,24V DC	110/220VAC,50/60Hz,24V DC
Operating Voltage Range	90~110% of Rated Voltage	90~110% of Rated Voltage
Power Consumption	10W(MAX.) 6W(Steady State)	10W(MAX.) 6W(Steady State)
Input Signal	40mA,PT100ohm,K,(1~5V)	4~20mA,PT100ohm,K,(1~5V)
Output Signal	DC4~20mA	AIR 1.4~2.4K
Control Action	DIRECT or REVERSE	DIRECT or REVERSE
Accuracy	+/-0.3% of Full Span	+/-0.3% of Full Span
Control Functions	PID Control Functions, Auto-Tuning	PID Control Functions, Auto-Tuning
Alarm Output	Relay Contact Output(A)	Relay Contact Output(A)
	Error LED Lamp	Error LED Lamp
Local Set Point Adjustment	UP/DOWN Push Button	UP/DOWN Push Button
Display	LED,FND Display	LED,FND Display
Adjustable Parameters	SV,PV,PID,Unit	SV,PV,PID,Unit
Self-Diagnostic	Watch-Dog Circuit	Watch-Dog Circuit
Communication(Optional)	RS232 or RS485(Option)	RS232 or RS485(Option)

Accessories

■ CONTROLLER



SLC-DT

Level controller

Nominal Pressure	Max. 25bar up to 250°C
Operating Temperature	1 to 250°C
Ambient Temperature	1 to 80°C
Density of Liquid	Min 0.7kg/dm ³
Control Connections	G1/8"(BSPP) inside thread
Supply Pressure	1.4 bar
Output Signal	0.2 to 1.0 bar
Linearity	±5%(of full scale output)
Protection grade	IP54
Control Action	P (proportional)

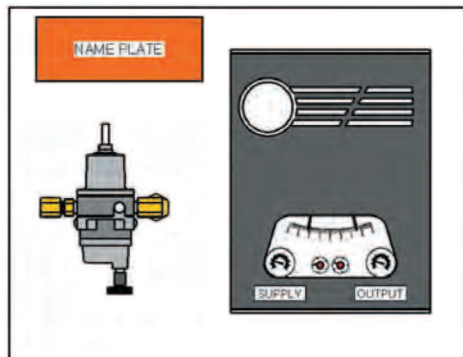

SPC-KMC83P

P & P pressure controller

Supply pressure	kgf/cm ²	1.4 ~ 4.0
Output pressure	kgf/cm ²	<input type="checkbox"/> 0.2~1.0 <input type="checkbox"/> 0.4~2.0
Measuring pressure	kgf/cm ²	<input type="checkbox"/> 0~10 <input type="checkbox"/> 0~16 <input type="checkbox"/> 0~20
Protection grade		IP54
Control action		<input type="checkbox"/> P.I <input type="checkbox"/> P.I.D

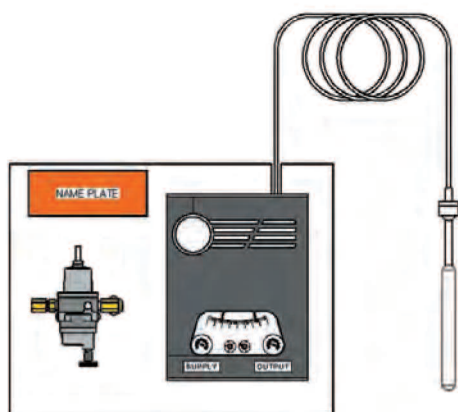

STC-KMC83R11

P & P temperature controller

Supply pressure	kgf/cm ²	1.4 ~ 4.0
Output pressure	kgf/cm ²	<input type="checkbox"/> 0.2~1.0 <input type="checkbox"/> 0.4~2.0
Temperature range	°C	<input type="checkbox"/> 0~100 <input type="checkbox"/> 0~150
Capillary tube length		<input type="checkbox"/> 5m <input type="checkbox"/> 7m <input type="checkbox"/> 10m
Protection grade		IP54
Connection(sensor pocket)		<input type="checkbox"/> PT 1/2 <input type="checkbox"/> PT 3/4"
Control action		<input type="checkbox"/> P.I <input type="checkbox"/> P.I.D

Accessories

■ POSITIONER

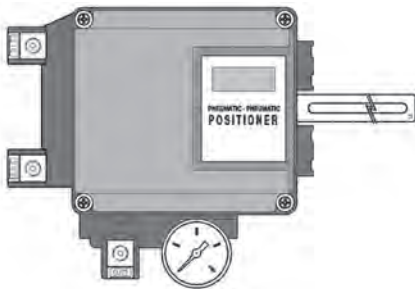

Pneumatic-Pneumatic Positioner

Operation type	Linear	
Input signal	kgf/cm ²	0.2~1.0 / 0.4~2.0
Supply pressure		1.4~7.0 kgf/cm ²
Air connection		PT 1/4"
Protection grade		IP66
Ambient temp.		-30°C~85°C
Material		Aluminum diecasting
Model No.		SPN-YT1200L

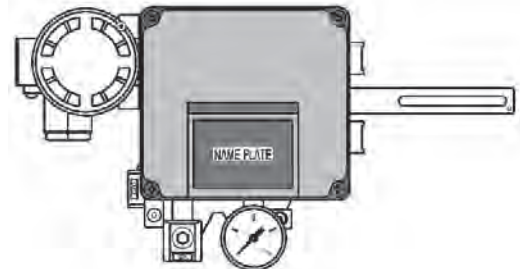

Electro-Pneumatic Positioner

Operation type	Linear	
Input signal		4~20mA
Supply pressure		1.4~7.0 kgf/cm ²
Air connection		PT 1/4"
Protection grade		IP66
Ambient temp.		-30°C~85°C
Material		Aluminum diecasting
Model No.		SPN-YT1000L

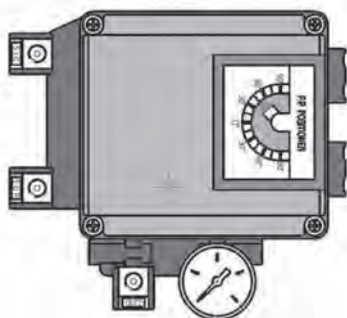

Pneumatic-Pneumatic Positioner

Operation type	Linear/Rotary, S/Hart	
Input signal	kgf/cm ²	0.2~1.0 / 0.4~2.0
Supply pressure		1.4~7.0 kgf/cm ²
Air connection		PT 1/4"
Protection grade		IP66
Ambient temp.		-30°C~85°C
Material		Aluminum diecasting
Model No.		SPN-YT3300L/R

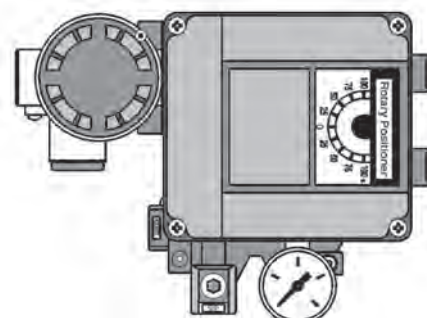

Electro-Pneumatic Positioner

Operation type	Rotary	
Input signal		4~20mA
Supply pressure		1.4~7.0 kgf/cm ²
Air connection		PT 1/4"
Protection grade		IP66
Ambient temp.		-30°C~85°C
Material		Aluminum diecasting
Model No.		SPN-YT1000R

Accessories

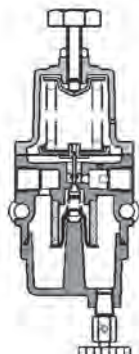

SAF-YT200A

Air filter regulator

Applicable fluid	Air	
Max. supply pressure	kgf/cm ²	15
Max. output pressure	kgf/cm ²	□4.2 □8.4
Air connection	PT 1/4"	
Material	Aluminum diecasting	

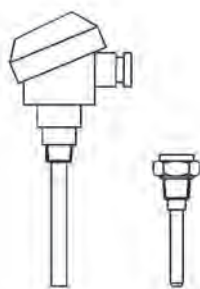

SRT-PT100SD

Temperature sensor

Temperature range	-60~200°C	
Protection grade	IP 54	
Cable gland	□15a	□20a
Connection	PT 1/2"	

Thermowell

Max. working temperature	220°C	
Max. working pressure	70kgf/cm ²	
Connection	□PT 1/2	□PT 3/4"

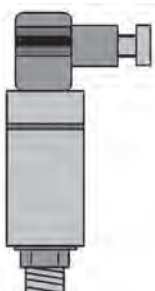

SRT-PT100SD

P/I (pressure to current) transducer

Supply voltage	DC24V(12~32V)	
Signal pressure	0.2~1.0kgf/cm ²	
Output signal	4~20mA	
Operating temperature range	-40°C ~ 125°C	
Cable gland	PG11.5(cable: Φ6.8~11.5)	
Connection	PT 1/4"	
Protection grade	IP65	



SRT-PT100SD

P/I (pressure to current) transducer

Input signal	4~20mA	
Output signal	0.2~1.0kgf/cm ²	
Air consumption	0.05m ³ /hr	
Supply pressure	7kgf/cm ²	
Temperature limits	-30°C ~ 65°C	
Cable gland	22GA. 3 wire leads	
Connection	1/4-20 NPT	
Protection grade	IP65	



PROFESSIONAL VALVE HOUSE



TAEIL M-TECH CO.,LTD

Office & Factory

47 Dasan-ro, Saha-gu, Busan, Korea 49499 Tel +82.51.262.7165 Fax +82.51.262.7168