



W.H SCOTT & SON ENGINEERS LTD
founded 1897

Manual Winches

Lifting Equipment | Crane Services | Height Safety
Inspection & Maintenance | Industrial Supplies

www.whscottlifting.com

Manual Winching

Brake Hand Winch BHW

The Tiger Brake Winch is a high quality multi-purpose winch used for a wide variety of lifting and hoisting applications. The automatic brake ensures the load remains suspended when the crank is released and avoids unchecked descent of the load; there is no freewheeling making the hand winch extremely safe to operate. All the mechanical components are enclosed for protection against dust, dirt and rain contamination. This equipment has a lifting capacity ranging from 800lbs to 2600lbs. The BHW is compact and lightweight yet rugged and durable. These units meet and exceed all the requirements within BS EN 13157:2004+A1:2009.

- High quality multi-purpose winch
- Automatic load-actuated brake can hold the load in any position
- Compact, light-weight and rugged construction
- Gears and brakes fully covered to prevent dust, dirt and rain contamination
- Heat treated gears
- Very low operator effort required for easy operation
- Dual handle pinion shaft option available on all models, allows handle to be fitted on both sides.
- Universal mounting plate
- Available as 800lb, 1200lb, 1800lb and 2600lb models.
- For cable and strap
- Finished in high quality powder coat paint offering excellent corrosion protection
- Available with OCP corrosion protection
- Noiseless 1200lb model available
- 3D Drawings available on full range for project planning
- Operating temperature of -20°C to +80°C (temperature range of -40°C to +80°C available as an option)



Dual handle option



Noiseless 1200lb option

Product Number	Pulling Capacity lbs/kg	Lifting Capacity lbs/kg			Gear Ratio	Hub Dia Ø mm	Handle Length mm	Unit Weight kg	Cable Diameter mm/inch	Cable Storage Cap. m	Strap Storage Cap. m
		First Layer	Mid Layer	Last Layer							
BHW-0800	800/360	800/360	560/254	400/180	4.1:1	Ø40	160	3.0	Ø4/Ø5/32	36	9.1
BHW-1200	1200/550	1200/550	864/392	600/275	4.1:1	Ø50	210	3.5	Ø5/Ø3/16	23	8.5
BHW-1800	1800/800	1800/800	1239/562	900/400	5:1	Ø70	320	8.0	Ø6/Ø1/4	24	14.1
BHW-2600	2600/1180	2600/1180	1861/844	1300/590	10:1	Ø82	320	10.5	Ø8/Ø5/16	18	10.6

Corrosion resistant version

This model is protected by our unique coating – OCP (Organic Compound Protection) The uniqueness of this coating gives unprecedented long term reliability and superior corrosion resistance and protection in the most severe conditions. The OCP coating provides excellent friction protection and has been proven to be effective through at least 1000 hours of the ASTM B 117 Salt Spray Test. The coating gives the properties of stainless steel without the cost implications.

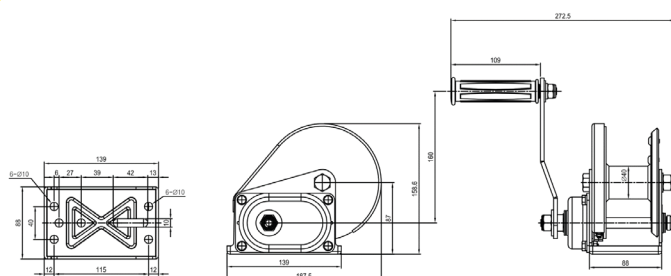

BHW - 0800

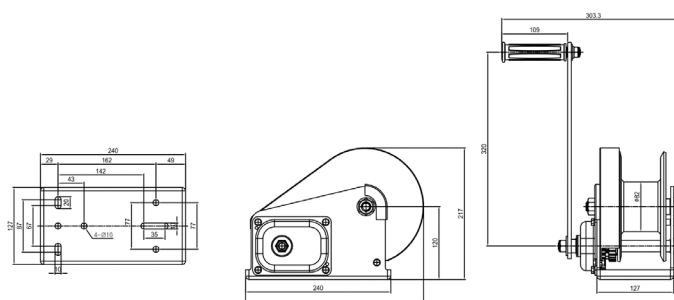

BHW - 2600

Winch Straps for pulling only

Product Number	Description	Width mm	Thickness mm	Breaking Load kg	Available For
TG-48	6m with safety hook	48	1.2	2068.5	BHW-0800 & BHW-1200
TG-54	9m with safety hook	54	1.4	2864.0	BHW-1800
TG-60	9m with safety hook	60	1.7	4136.0	BHW-2600

Wire Rope

Product Number	Description	Diameter mm	Breaking Load kg	Available For
WWR-04-03	30m with safety hook	4	1270	BHW-0800
WWR-05-20	20m with safety hook	5	2000	BHW-1200
WWR-06-22	22m with safety hook	6	3000	BHW-1800
WWR-08-16	16m with safety hook	8	4500	BHW-2600

Ceiling Mounted Winches

Ceiling Mount Winch

SF-5000 (wire)/SF-5000-S (strap)

- 5000lb/2270kg capacity
- Split reel, which allows for operation of two cables
- Loop drive allows the winch to be mounted out of reach and operated with an extension pole fitted to engage the loop
- Positive load-actuated brake can hold the load in any position
- Gears and brake are fully covered to prevent dust, dirt and rain contamination
- Very low operator effort is required for easy operation



Electric Ceiling Mount Winch

SF-5000E (wire)/SF-5000E-S (strap)

- 5000lb/2270kg capacity
- Compact and light weight
- Split reel, which allows for operation of two cables
- Completely sealed to prevent dust, dirt and rain contamination
- Brake motor for quick and safe stopping
- Very low operator effort is required for easy operation
- Powerful and smooth
- Can be operated manually during power failure (option)



Heavy Duty Worm Gear Winch WL-4600

- 4600lb/2090kg capacity
- Self-braking
- Available in regular or split reel, which allows for operation of two line or cables for greater versatility
- Completely sealed to prevent dust, dirt and rain contamination



Ceiling Mounted Winches

cont. - dimensions/drawings

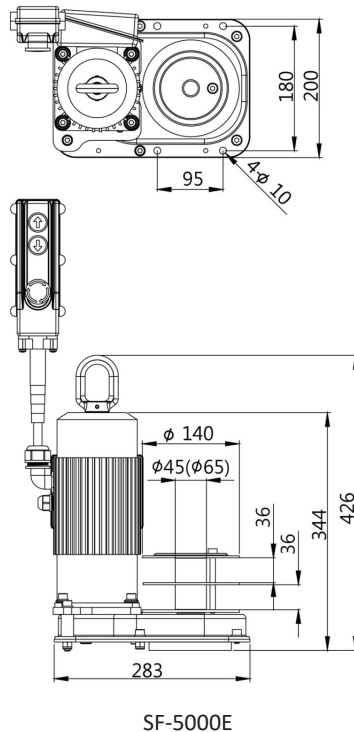

SF-5000E

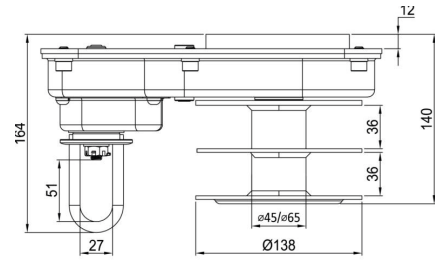

SF-5000

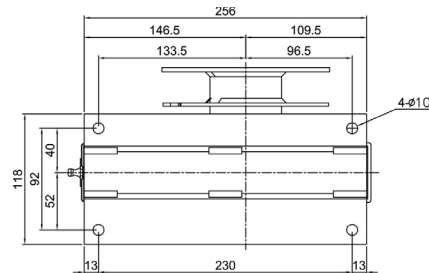

WL-4600

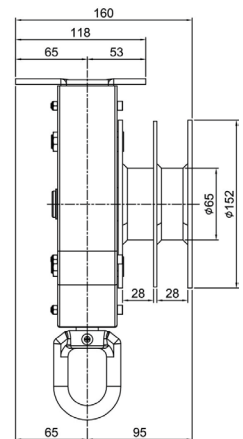

Drum diameter:
SF-5000 (for wire) = Ø65mm
SF-5000 (for strap) = Ø45mm

Other loop sizes available

Product Number	Lifting Capacity First Layer	Lifting Capacity Last Layer	Hand Force kg	Gear Ratio	Hub Diameter mm	Unit Weight (with loop) kg	Cable Diameter mm / inch	Cable Storage Cap. m
SF-5000	5000/2270	2670/1210	4	90.24:1	Ø65	9.3	Ø6.4 / Ø1/4	11*2
SF-5000-S	5000/2270	2670/1210	4	90.24:1	Ø45	9.3	-	4.5*2
SF-5000E	5000/2270	2670/1210	-	90.24:1	Ø65	23.14	Ø6.4 / Ø1/4	11*2
SF-5000E-S	5000/2270	2670/1210	-	90.24:1	Ø45	23.14	-	4.5*2
WL-4600	4600/2090	2285/1035	6	65:1	Ø65	12.5	Ø6.4 / Ø1/4	11*2

Hand Winches



General Purpose Hand Winch
HW-2000

- 2000lb/900kg capacity
- Available in regular or split reel, which allows for operation of two line or cables for greater versatility
- Available in handle or loop drive models
- Can be ceiling mounted with loop drive
- Operating temperature -20°C to +80°C (temperature range of -40°C to +80°C available as an option)

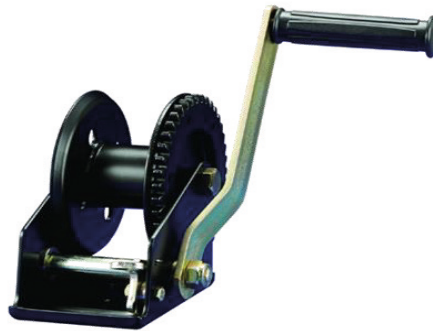

General Purpose Hand Winch
Winch HW-1200

- 1200lb/545kg capacity
- Ability to disengage the gear to allow fast pay out of the cable



General Purpose Hand Winch
Winch HW-0600

- 600lb/270kg capacity
- Ability to disengage the gear to allow fast pay out of the cable

Product Number	Pulling Capacity lbs/kg	Hand Force Required kg	Gear Ratio	Hub Diameter mm	Handle Length mm	Unit Weight (with handle) kg	Unit Weight (with loop) kg	Cable Diameter mm / inch	Cable Storage Cap. m
HW-0600	600/270	7.0	3.1:1	Ø19	175	*2.26	-	Ø4.0 / Ø5/32	28
HW-1200	1200/545	20.0	4.1:1	Ø50	210	*2.84	-	Ø4.8 / Ø3/16	29
HW-2000	2000/900	4.5	41:1	Ø48	195	*5.1	*4.8	Ø5.6 / Ø7/32	11*2

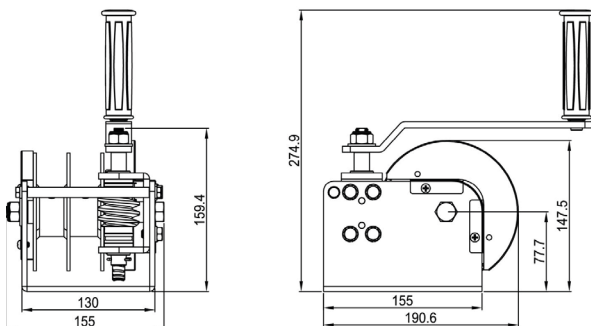
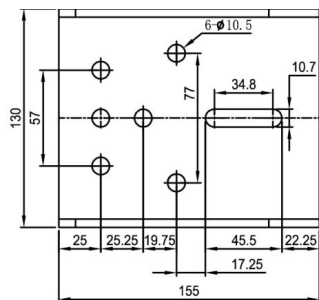

HW-2000 (with handle)

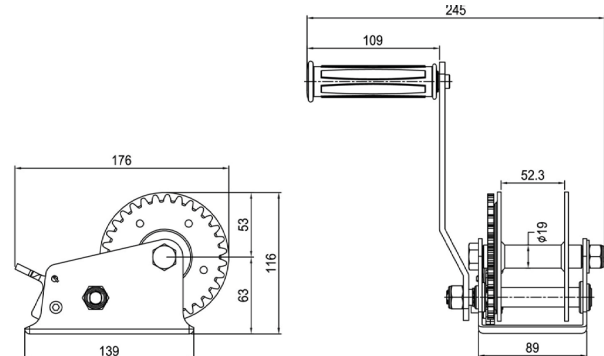
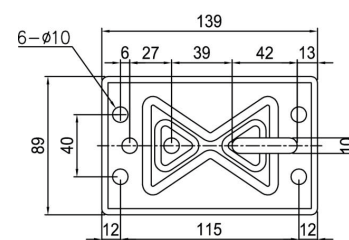

HW-600

Industrial Winch

- 2200lb/1000kg lifting & 4400lb/2000kg pulling capacity
- Ratchet handle permits reciprocating handle movement in both directions for lifting and lowering loads
- Positive load-actuated brake can hold the load in any position
- Gears and brake are fully covered to prevent dust, dirt and rain contamination
- Very low operator effort is required for easy operation
- Ratchet handle accommodates installation in cramped locations such as wall and floor

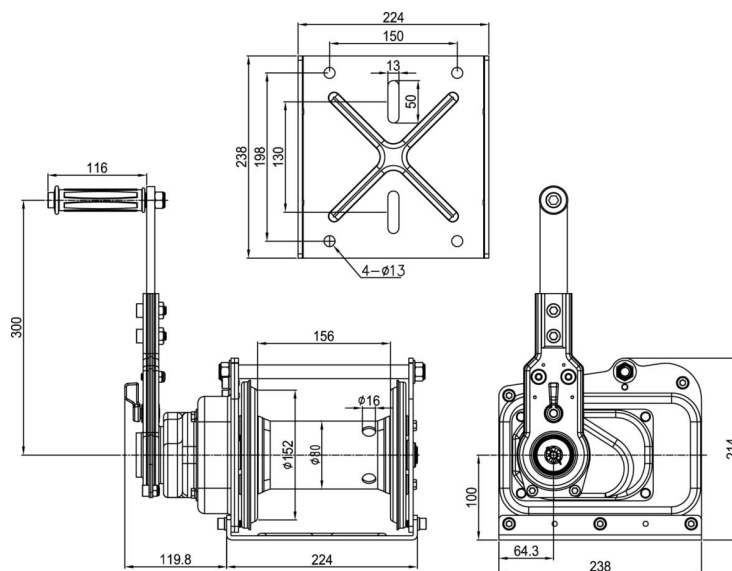
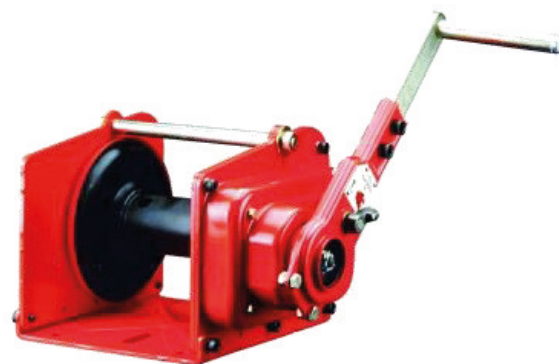

Product Number	Pulling Capacity lbs/kg	Lifting Capacity lbs/kg	Hand Force Required kg	Gear Ratio	Hub Diameter mm	Handle Length mm	Unit Weight (with handle) kg	Cable Diameter mm / inch	Cable Storage Cap. m
SF-2200	4400/2000	2200/1000	10	22.2:1	$\phi 80$	300	17.5	$\phi 8.0 / \phi 5/16$	45

Bespoke Winches

We produce standard worm-gear and planetary-driven winches for lifting, pulling, man-riding, mooring and anchoring. They range from 100 kg to 100 tons and are electrically, hydraulically or pneumatically driven.

Capstans

We provide rugged, self-contained worm gear or planetary capstan systems with electric, hydraulic or pneumatic transmission. All capstans can be ATEX-rated, where required. We can also equip capstans with watertight or drip-waterproof motors and self-aligning mounting plates for high static loads.

Umbilical Winches

We provide rugged, self-contained worm gear or planetary capstan systems with electric, hydraulic or pneumatic transmission. All capstans can be ATEX-rated, where required. We can also equip capstans with watertight or drip-waterproof motors and self-aligning mounting plates for high static loads.



A huge range of bespoke winches available, contact the WH Scott team for more information.

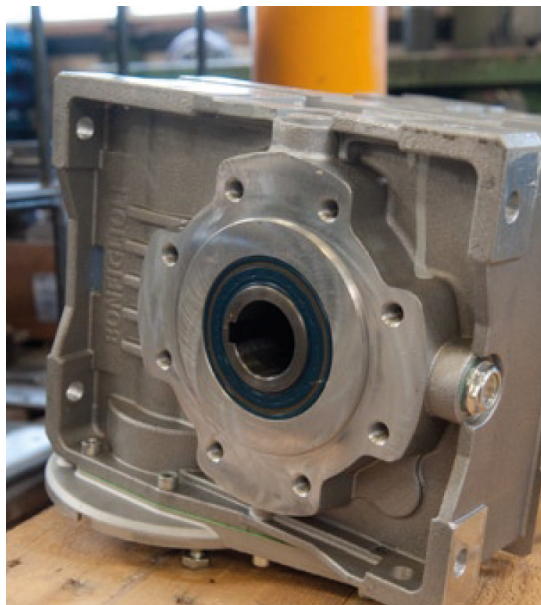

sales@whscottlifting.com





W.H SCOTT & SON ENGINEERS LTD
founded 1897



sales@whscottlifting.com
www.whscottlifting.com

Dublin Depot

65 Broomhill Road,
Tallaght,
Dublin 24
Co. Dublin
Ireland
+353 (0) 1 885 5333

Belfast Depot

Unit 6 Highgate Business Park,
16-44 Trench Rd,
Newtownabbey,
BT36 4TY
Northern Ireland
+44 (0) 28 9083 1780

Wexford Depot

Taghmon Business Park,
Poulmarle
Taghmon,
Co. Wexford,
Ireland
+353 (0) 53 918 3990

Liverpool Depot

Unit 26,
Sandon Industrial Estate,
Sandon Way,
Liverpool,
L5 9YN
+44 (0) 151 372 0290

Plymouth Depot

Devonport Royal Dockyard
Devonport
Plymouth
Devon
PL1 4SG
+44 (0)