

## ZETFON 50/650K and ZETFON 120/330K

The ZÖLLNER ZETFON 50/650K and ZETFON 120/330K are a robust electrically operated whistles. Each ZETFON consists as standard of one horn, one control and amplifier unit and one illuminated built-in key for the release.

### Essentials

- » full compliance with the COLREG 1972
- » type approved by all wellknown international authorities and classification societies
- » entirely made of best non-corrosion, seawaterresistant materials (no plastic!)

#### Application:

- » vessels of less than 20 meters
- » land alarm, i.e. bunker stations, oil refineries, airports, power plants, factories

#### Options:

- » heating (10 W) for Loudspeaker
- » speaker function for ZETFON 120/330K

### Sound Characteristics

- » broad frequency spectrum with many higher harmonics
- » signals with strong overtones for best penetration of background noise level. Two or three harmonics are sufficient for the hearing to perceive the basic frequency.
- » sound pressure level >120 dB in 1/3rd octave band level at 1 m distance

### Advantages

- » maintenance free
- » decades of experience
- » best material and workmanship - made in Germany
- » control and amplifier unit with protection against cross-connection for supply voltage

#### Easy installation:

- » only one 2-core cable required for standard unit
- » low weight
- » easy exchange of all parts with onboard tools



## Technical information

## ZETFON 70s

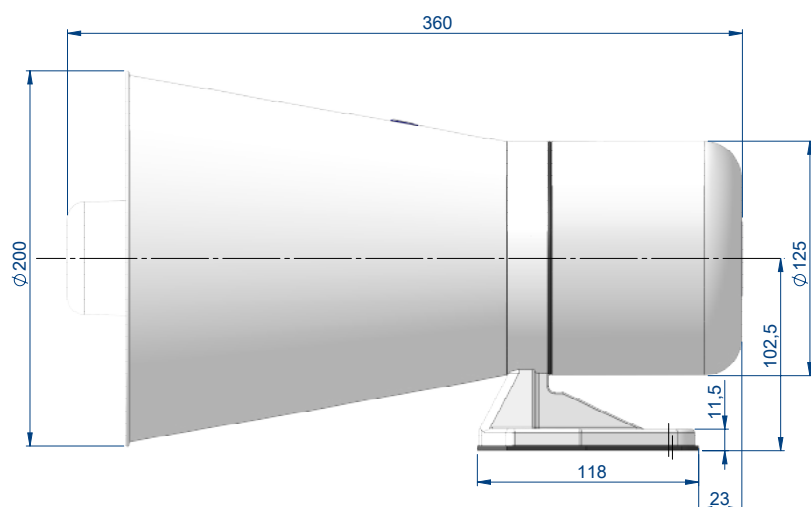

drawing 0144715

weight approx. 3,3 kg

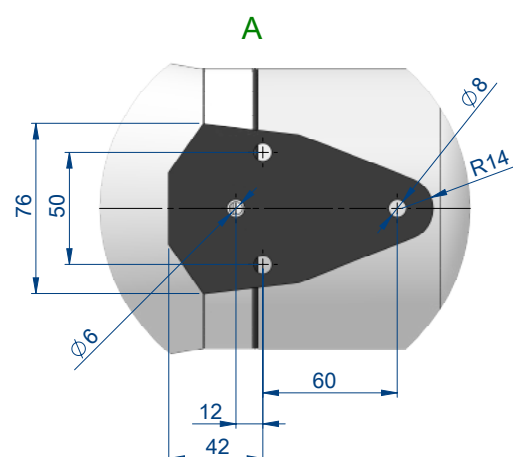

## Control and Amplifier Unit

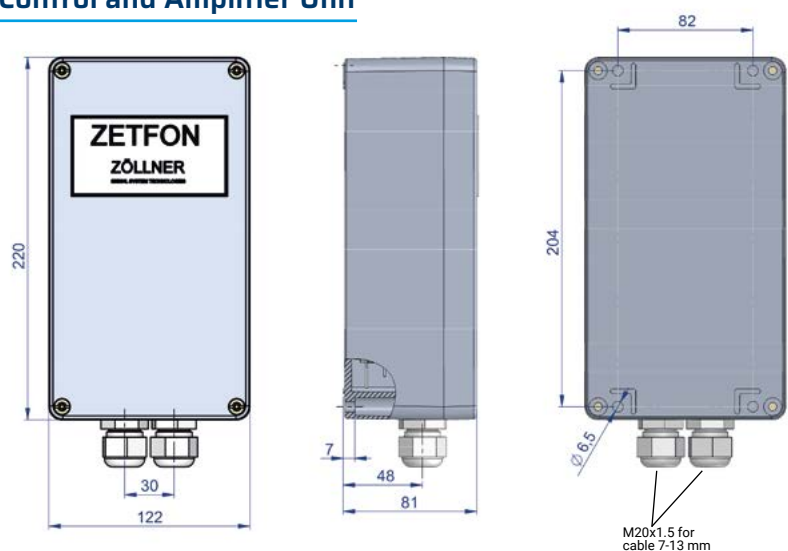

drawing 01416025

weight approx. 2,8 kg

### Illuminated built-in Key

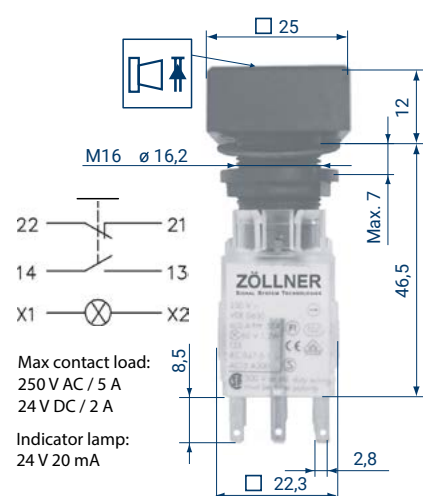

drawing 0144676

weight approx. 0,085 kg

TYPE	SHIP LENGTH	FUNDAMENTAL FREQUENCY	SOUND INTENSITY IN 1/3RD-OCT. BAND LEVEL AT 1 M (MIN. 120 DB ACC. TO IMO)	TYPE APPROVAL	CONTROL AND AMPLIFIER UNIT	SYSTEM VOLTAGE	PROTECTION TYPE	PROTECTION CLASS
ZETFON 50/650K	<20 m	650 Hz	120 dB	✓	ZP 7	24 V DC 12 V DC	IP 56	IP 56
ZETFON 120/330K	<20 m	330 Hz	120 dB	✓	ZP 8	24 V DC	IP56	IP 56